

**NOTICE OF PUBLIC EIR SCOPING MEETING
AND REQUEST FOR WRITTEN SCOPING COMMENTS
REGARDING THE CRYSTAL CREEK AGGREGATES EXPANSION PROJECT**

PROJECT TITLE: Crystal Creek Aggregate Expansion Project (General Plan Amendment 19-0003, Zoning Plan Amendment 19-0002, Use Permit Amendment 19-0007, and Reclamation Plan Amendment 19-0001) **APPLICANT:** Crystal Creek Aggregate Inc. 10936 Iron Mountain Road Redding, CA 96001. **PROJECT LOCATION:** The project site is located on an existing quarry located in the community of Keswick, on the west side of Iron Mountain Road, approximately 1.5 miles north of the intersection of Iron Mountain Road and State Highway 299 West. The project site includes Assessor's Parcel numbers 065-250-002-000, 065-250-024-000, 065-250-025-000, 065-250-026-000, 065-260-010-000.

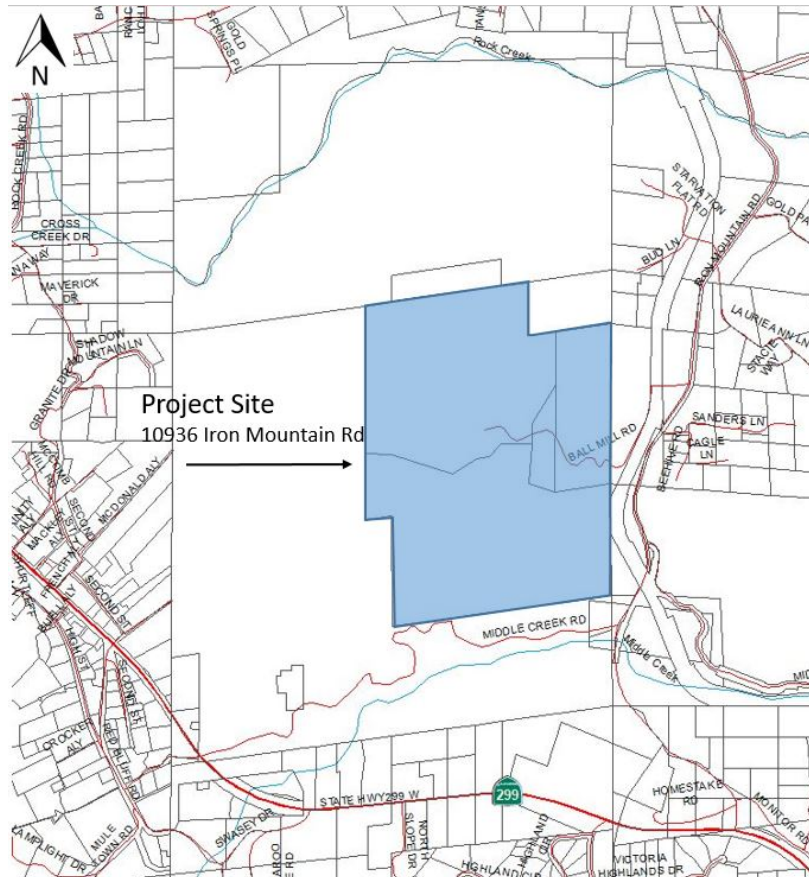

Shasta County is the Lead Agency under the California Environmental Quality Act (CEQA), and is preparing an Environmental Impact Report (EIR) for the project identified as the Crystal Creek Aggregate Expansion Project. Crystal Creek Aggregate, Inc. proposes to expand their existing aggregate mining operation and add an asphalt batch plant. The project would expand an approved mining use permit area of 110.24 acres and an approved reclamation plan area of 108.87 acres to 179.97 acres. The project would require a General Plan amendment from Natural Resource Protection-Open Space (N-O) to Mineral Resource (MR), and a Zoning Plan amendment from Unclassified (U) to Mineral Resource (MR).

The purpose of the scoping meeting is to solicit guidance as to the scope and content of the EIR, including potential environmental impacts of concern and mitigation measures or alternatives that should be considered.

The probable environmental effects of the project include, but are not limited to, aesthetics, biological resources, greenhouse gas emissions, land use, traffic, forestry resources, cultural resources, hazards & hazardous materials, public services, tribal cultural resources, air quality, geology/soils, hydrology/water quality, noise, and utilities/services systems. A detailed project description is included in the Notice of Preparation filed with the California State Clearinghouse on September 30, 2019. The Notice of Preparation of an EIR can be reviewed at:

<https://www.co.shasta.ca.us/docs/libraries/resource-management-docs/eir/crystal-creek-aggregate/nopclearinghousemailer.pdf>

A copy of the Notice of Preparation can also be reviewed or obtained at the Shasta County Dept. of Resource Management, Planning Division located at 1855 Placer Street, Suite 103, Redding, CA 96001.

PUBLIC SCOPING MEETING NOTICE: Shasta County will hold a public scoping meeting for agencies and individuals to learn more about the CEQA process for this project, and to receive comments about the scope and content of the EIR, including what potential environmental impacts of the project should be addressed in depth in the EIR. The merits of the project will not be discussed at this meeting, nor will comments regarding approval or denial of the project. No decision to approve or deny the project will be made at this meeting. The meeting will be held Friday November 1, 2019 at 9:00 AM, in the Shasta County Department of Public Works Conference Room, located at 1855 Placer Street.

WRITTEN SCOPING COMMENTS: The written scoping comment period for this project is extended until Friday November 8, 2019. Send all direct questions and all written comments to the project contact, Tara Petti, Assistant Planner, at the Shasta County Department of Resource Management, Planning Division, 1855 Placer Street, Suite 103, Redding, CA 96001, or via e-mail at tpetti@co.shasta.ca.us. Ms. Petti may be contacted for additional information at (530) 225-5532.